

OKLAHOMA DEPARTMENT OF TRANSPORTATION					
FED. ROAD DIST. NO.	STATE	JOB RECD. NO.	FISCAL YEAR	SHEET NO.	TOTAL SHEETS
6	OKLA.				
DESCRIPTION		REVISIONS		DATE	

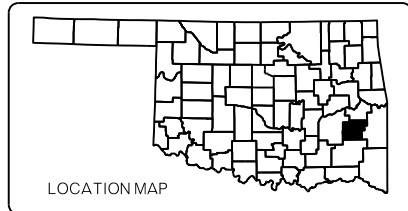

STATE OF OKLAHOMA  
DEPARTMENT OF TRANSPORTATION

PLAN OF PROPOSED  
**STATE HIGHWAY**  
PROJECT NO. STP-NBIP(519)3B  
DIVISION 2 PREVENTIVE MAINTENANCE BRIDGE PAINTING  
SH-2 OVER FOURCHE MALINE CREEK  
**LATIMER COUNTY**

CONTROL SECTION NO. 02-39-10  
STATE JOB NO. 33217(05)  
BRIDGE "A" LOCATION NO. 3910 0232 X  
NBI NO. 13678

INDEX OF SHEETS

SHEET NUMBER	SHEET DESCRIPTION
0001	TITLE SHEET
AB01	GENERAL NOTES AND SUMMARY OF PAY QUANTITIES (BRIDGE)
AT01	SUMMARY OF PAY QUANTITIES AND NOTES (TRAFFIC)
B001	GENERAL PLAN AND TYPICAL SECTION (BRIDGE "A")
T001	TRAFFIC CONTROL DETAIL (BRIDGE "A")

**TRAFFIC DESIGN**  
PROJECT ENGINEER: T. MAAROUF  
SQUAD SUPERVISOR: B. ABRAHAM

**BRIDGE DESIGN**  
SQUAD SUPERVISOR: R. HENSLEY  
SQUAD MEMBERS: T. ELDRIDGE, P. GAFFORD, B. JONES, D. NASH, M. WANZER

ENGINEERING MANAGER: P. DEFRANCO, PE  
ENGINEER: C. OSBORNE, PE  
ENGINEER: A. LEBSACK, EIT

STANDARDS TO BE INCLUDED

- TRAFFIC**
- TCS1-1-01
  - TCS2-1-00
  - TCS3-1-01
  - TCS5-1-00
  - TCS6-1-02
  - TCS7-1-02
  - TCS9-1-01
  - TCS11-1-01
  - TCS14-1-00
  - TCS20-1-00

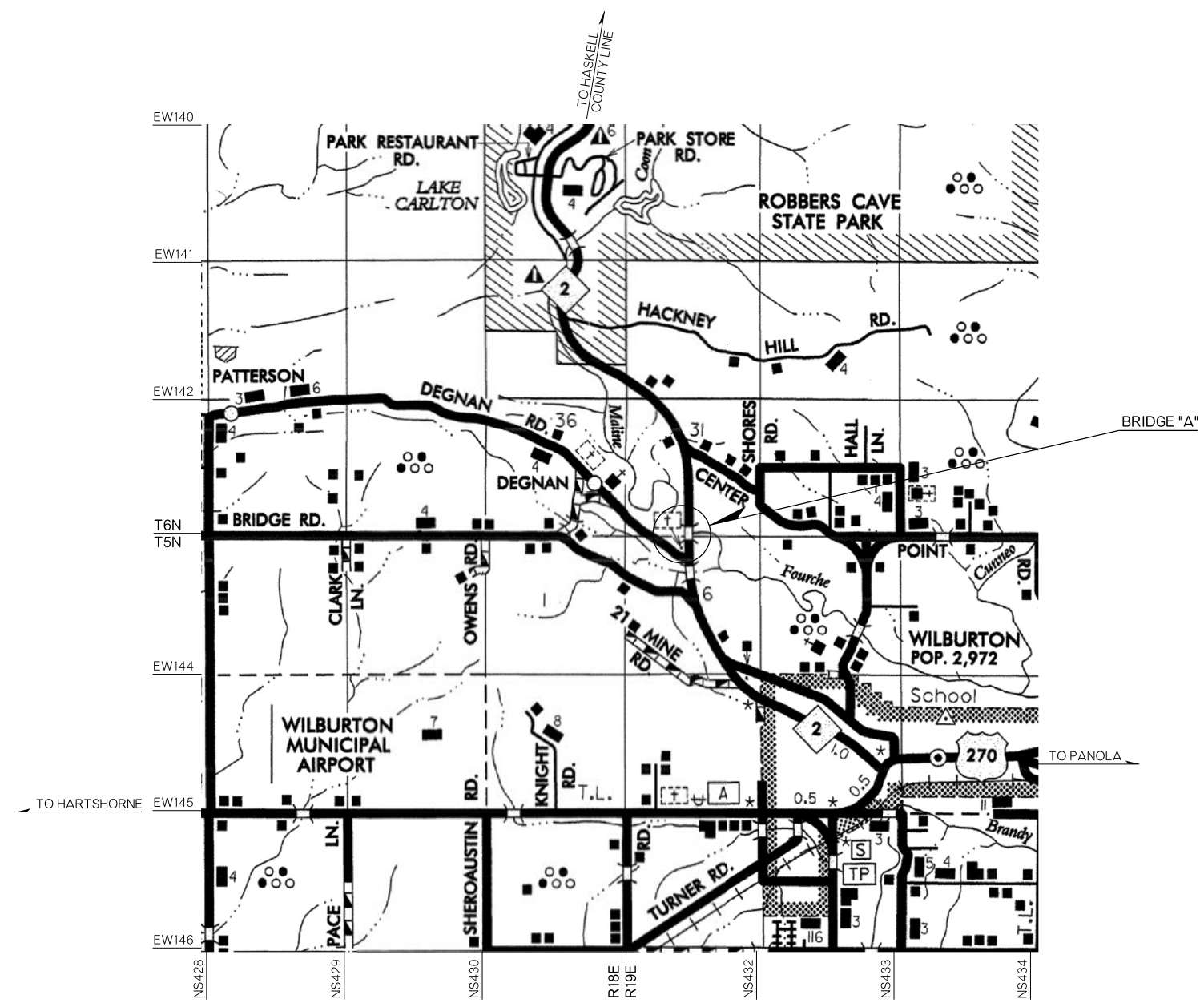

CONVENTIONAL SYMBOLS

- PROPOSED ROAD
- RAILROADS
- RANGE & TOWNSHIP SECTION LINES
- QUARTER SECTION LINES
- FENCES
- GROUND LINE
- EXISTING ROADS
- BASE LINE
- GRADE LINES
- TELEPHONE & TELEGRAPH
- POWER LINES
- BUILDINGS
- OILWELL
- DRAINAGE STRUCTURES - IN PLACE
- DRAINAGE STRUCTURES - NEW
- RIGHT-OF-WAY LINES - EXISTING
- RIGHT-OF-WAY LINES - NEW
- CONTROLLED ACCESS
- RIGHT-OF-WAY FENCE

2009 OKLAHOMA STANDARD SPECIFICATIONS FOR HIGHWAY CONSTRUCTION GOVERN, APPROVED BY THE U.S. DEPARTMENT OF TRANSPORTATION, FEDERAL HIGHWAY ADMINISTRATION, JANUARY 4, 2010.

PREPARED BY:  
OKLAHOMA DEPARTMENT OF TRANSPORTATION  
BRIDGE DESIGN DIVISION  
*Patty F. DeFranco*  
PATTY F. DEFRANCO, P.E.  
OKLA. REG. NO. 20916  
DATE 7/13/2017

OKLAHOMA DEPARTMENT OF TRANSPORTATION  
DATE APPROVED \_\_\_\_\_  
BY \_\_\_\_\_  
CHIEF ENGINEER

DEPARTMENT OF TRANSPORTATION  
FEDERAL HIGHWAY ADMINISTRATION  
DATE APPROVED \_\_\_\_\_  
BY \_\_\_\_\_  
DIVISION ADMINISTRATOR

SWO \_\_\_\_\_ PROJECT NO. STP-NBIP(519)3B  
COUNTY LATIMER HIGHWAY SH-2 SHEET NO. 0001

P.E. NO. : 33217(01)

REVISIONS		
REV. NO.	DESCRIPTION	DATE
1	ADD ENVIRO NOTES	8/14/17

**GENERAL NOTES**

**SPECIFICATIONS:**

COMPLY WITH THE REQUIREMENTS OF THE 2009 STANDARD SPECIFICATIONS FOR HIGHWAY CONSTRUCTION, EXCEPT AS MODIFIED BY THE PLANS AND SPECIAL PROVISIONS.

**PLANS:**

CONSTRUCTION PLANS FOR THE EXISTING STRUCTURES, MAY BE OBTAINED FROM THE OFFICE SERVICES DIVISION OF THE OKLAHOMA DEPARTMENT OF TRANSPORTATION.

OFFICE SERVICES DIVISION  
OKLAHOMA DEPARTMENT OF TRANSPORTATION  
200 NE 21ST STREET  
OKLAHOMA CITY, OKLAHOMA 73105

ASK FOR:  
BRIDGE "A": FAP-F-285(1), SH-2 OVER FOURCHE MALINE CREEK IN LATIMER COUNTY

**VERIFICATION OF EXISTING CONDITIONS:**

ALL DIMENSIONS OF THE EXISTING BRIDGE COMPONENTS SHOWN ON THE PLANS ARE APPROXIMATE. THE CONTRACTOR SHALL VERIFY ALL DIMENSIONS NECESSARY TO COMPLETE THE PROJECT AS DESCRIBED AND SHALL BE SOLELY RESPONSIBLE FOR THE ACCURACY THEREOF.

BIDDERS SHALL FULLY INFORM THEMSELVES OF THE NATURE OF THE WORK AND CONDITIONS UNDER WHICH IT WILL BE PERFORMED. THE CONTRACTOR SHALL ADOPT METHODS CONSISTENT WITH GOOD CONSTRUCTION PRACTICE AND SHALL TAKE ALL NECESSARY PRECAUTIONS TO PREVENT DAMAGE TO ANY EXISTING BRIDGE STRUCTURE OR ROADWAY. ANY DAMAGE TO THE BRIDGE STRUCTURE OR ROADWAY DUE TO THE CONTRACTOR'S NEGLIGENCE SHALL BE REPAIRED AT THE CONTRACTOR'S EXPENSE, TO THE SATISFACTION OF THE ENGINEER.

**EXPOSURE OF DETERIORATED STRUCTURAL STEEL:**

IF ANY DETERIORATED STRUCTURAL STEEL IS EXPOSED DURING SAND BLASTING, THE CONTRACTOR SHALL BE RESPONSIBLE FOR NOTIFYING THE ENGINEER, WHO IN TURN SHALL NOTIFY THE BRIDGE ENGINEER AS TO THE EXTENT OF THE DAMAGE. THE BRIDGE ENGINEER SHALL DETERMINE IF ANY REPAIRS ARE NECESSARY AND IF SO, WHAT METHOD OF REPAIR SHALL BE USED.

**REMOVED MATERIAL:**

ALL MATERIAL AND DEBRIS REMOVED DURING THIS PROJECT SHALL BECOME THE PROPERTY OF THE CONTRACTOR AND SHALL BE DISPOSED OF IN A MANNER APPROVED BY THE ENGINEER.

**CLEANING BRIDGE SEATS AND PIER CAPS:**

ALL BRIDGE SEATS AND PIER CAPS SHALL BE SWEEPED CLEAN OF ALL DEBRIS. ALL COSTS CLEANING THE BRIDGE SEATS AND PIER CAPS SHALL BE PAID FOR IN OTHER ITEMS OF WORK.

**LANE CLOSURE:**

THE ENGINEER RESERVES THE RIGHT TO PROHIBIT LANE CLOSURES DURING HOLIDAYS OR SPECIAL EVENTS.

**GOOD-HOUSEKEEPING REQUIREMENT:**

MATERIAL STORAGE, CHEMICAL STORAGE, TRASH, SANITARY FACILITIES, ETC. SHOULD BE LOCATED NO CLOSER THAN 50 FEET FROM THE BANK OF ANY WATERS IN ORDER TO PROTECT WATER QUALITY. DEBRIS SHALL NOT BE BURIED WITHIN LIMITS OF RIGHT-OF-WAY.

**PAY ITEM NOTES**

**(1) PAINT REMOVAL AND PAINTING STRUCTURAL STEEL: (BRIDGE "A")**

ALL STRUCTURAL STEEL OF THE BRIDGE, INCLUDING BEAMS, DIAPHRAGM COMPONENTS, CONNECTION ASSEMBLIES, BEARING ASSEMBLIES, DRAIN PIPES, AND ANY STEEL USED FOR REPAIRS SHALL BE CLEANED AND PAINTED. ALL STRUCTURAL STEEL MENTIONED ABOVE AND ANY STEEL USED FOR REPAIRS SHALL BE CLEANED AND PAINTED IN ACCORDANCE WITH SECTION 512 OF THE STANDARD SPECIFICATION USING CATEGORY "E" APPLICATION. A QP-2 WILL BE REQUIRED FOR THIS PROJECT. ALTERNATIVELY, THE CONTRACTOR MAY HAVE PERSONNEL WITH SSPCC-3 SUPERVISOR/COMPETENT PERSON TRAINING FOR DELEADING OF INDUSTRIAL STRUCTURES. IF THE CONTRACTOR ELECTS TO USE THE C-3 TRAINING, THEY MUST PROVIDE A CURRENT CERTIFICATE SHOWING SUCCESSFUL COMPLETION OF THE C-3 TRAINING. THE CERTIFICATE MUST BE PROVIDED WITH THEIR BID PROPOSAL OR NOT LATER THAN THE WEDNESDAY FOLLOWING THE BID LETTING. IN ADDITION, THE SUPERVISOR WITH THE C-3 LEAD TRAINING WILL BE REQUIRED TO BE PRESENT AT THE PROJECT SITE THE ENTIRE TIME THAT DELEADING OPERATIONS ARE TAKING PLACE ON THE PROJECT SITE. THE EXISTING PAINT SYSTEM CONTAINS LEAD PAINT.

THE WEIGHT OF STRUCTURAL STEEL TO BE PAINTED FOR THE BRIDGES WAS ESTIMATED FROM THE EXISTING BRIDGE PLANS AND OBSOLETE STANDARDS LISTED THEREIN. THE STATE ASSUMES NO RESPONSIBILITY FOR THE ACCURACY THEREOF. NO COMPENSATION WILL BE ALLOWED FOR ERRORS IN THE ESTIMATED WEIGHT. THE ESTIMATED WEIGHT. THE ESTIMATED WEIGHTS OF STRUCTURAL STEEL FOR THE BRIDGES ARE:

BRIDGE "A": 349,380 POUNDS (APPROXIMATELY 20,339 S.F.)

ESTIMATED WEIGHTS AND AREAS ARE PROVIDED FOR CONTRACTOR'S CONVENIENCE. ACTUAL QUANTITIES MAY VARY.

ALL COSTS INCLUDING LABOR, EQUIPMENT, MATERIAL, AND INCIDENTALS NECESSARY TO COMPLETE THE WORK DESCRIBED ABOVE AND AS SHOWN IN THE PLANS SHALL BE INCLUDED IN THE LUMP SUM PRICE BID FOR "PAINTING EXISTING STRUCTURE" AND THE LUMP SUM PRICE BID FOR "COLLECTION AND HANDLING OF WASTE".

**(2) CLEANING AND PAINTING BRIDGE METAL RAIL: (BRIDGE 'A')**

PAY ITEM "CLEANING AND PAINTING BRIDGE METAL RAIL" CONSISTS OF CLEANING AND PAINTING OF THE BRIDGE METAL TRAFFIC RAILS AS SPECIFIED IN SECTION 512 OF THE STANDARD SPECIFICATIONS FOR A CATEGORY "E" APPLICATION.

THE PAINT SYSTEM AND APPLICATION THERE OF SHALL BE IN ACCORDANCE WITH SECTION 730 "PAINT FOR STRUCTURAL STEEL" OF THE STANDARD SPECIFICATIONS.

COLLECTION AND HANDLING OF WASTE FROM THE METAL TRAFFIC RAILS SHALL BE IN ACCORDANCE WITH SECTION 512 OF THE STANDARD SPECIFICATION FOR HAZARDOUS AND NON-HAZARDOUS WASTE.

ALL COSTS OF CLEANING AND PAINTING OF METAL TRAFFIC RAILS INCLUDING LABOR, MATERIAL, COLLECTION AND HANDLING OF WASTE AND OTHER INCIDENTALS SHALL BE INCLUDED IN THE PRICE BID PER LINEAR FOOT OF "CLEANING AND PAINTING BRIDGE METAL RAIL".

**ENVIRONMENTAL MITIGATION NOTES**

**BAT NOTE:**

THE NORTHERN LONG-EARED BAT IS A THREATENED BAT SPECIES THAT OCCURS WITHIN THE PROJECT'S ACTION AREA. BASED ON PROJECT PLANS, NO TREE REMOVAL WILL OCCUR AS PART OF THIS PROJECT. IN ORDER TO AVOID ADVERSE IMPACTS TO THIS SPECIES, BRIDGE REPAIR, RETROFIT, MAINTENANCE, REHABILITATION OR DEMOLITION SHALL BE RESTRICTED TO BETWEEN NOVEMBER 16, AND MARCH 31, OUTSIDE OF THE ACTIVE SEASON. IF BRIDGE REPAIR, RETROFIT, MAINTENANCE, REHABILITATION OR DEMOLITION DURING THE ACTIVE SEASON (BETWEEN APRIL 1, AND NOVEMBER 15) CANNOT BE AVOIDED, THE RESIDENT ENGINEER SHALL CONTACT THE ODOT BIOLOGIST AT 405-521-2515 TO SCHEDULE A BAT BRIDGE INSPECTION, PRIOR TO ANY BRIDGE WORK.

BRIDGE INSPECTION/ SURVEYS CAN ONLY BE CONDUCTED BETWEEN MAY 15, AND AUGUST 15, AND ARE VALID ONLY UNTIL THE FOLLOWING MARCH 31. IF THE SURVEY FINDS LISTED BAT SPECIES USING THE BRIDGE/STRUCTURE, BRIDGE REPAIR, RETROFIT, MAINTENANCE, REHABILITATION OR DEMOLITION SHALL ONLY BE PERMITTED BETWEEN NOVEMBER 16, AND MARCH 31, WHEN BATS ARE HIBERNATING IN CAVES.

**MIGRATORY BIRD:**

MIGRATORY BIRDS ARE PROTECTED BY THE FEDERAL MIGRATORY BIRD TREATY ACT. MANY BIRDS COMMONLY USE BRIDGES AND CULVERTS FOR NESTING. THE NESTING SEASON FOR MOST BIRD SPECIES EXTENDS FROM APRIL 1 TO AUGUST 31. NO SURVEY WAS DONE ON THIS PROJECT. THE RESIDENT ENGINEER SHALL CONTACT THE ODOT BIOLOGIST AT 405-521-2515 IF ANY BIRD USE OF THE EXISTING STRUCTURES IS OBSERVED. IF BIRDS ARE OBSERVED THEN PAINTING OF THE EXISTING BRIDGE/STRUCTURES SHALL BE CONDUCTED BETWEEN SEPTEMBER 1, AND MARCH 31, WHEN MIGRATORY BIRD NESTS ARE NOT OCCUPIED. THE BRIDGE MAY BE PROTECTED FROM NEW NEST ESTABLISHMENT PRIOR TO APRIL 1, BY MEANS THAT DO NOT RESULT IN BIRD DEATH OR INJURY. OPTIONS INCLUDE THE EXCLUSION OF ADULT BIRDS FROM SUITABLE NEST SITES ON OR WITHIN A STRUCTURE BY THE PLACEMENT OF WEATHER-RESISTANT POLYPROPYLENE NETTING WITH 0.25-INCH OR SMALLER OPENINGS, PRIOR TO APRIL 1. METHODS OTHER THAN NETTING MUST BE PRE-APPROVED BY THE ODOT BIOLOGIST.

**GOOD-HOUSEKEEPING REQUIREMENT:**

MATERIAL STORAGE, CHEMICAL STORAGE, TRASH, SANITARY FACILITIES, ETC. SHOULD BE LOCATED NO CLOSER THAN 50 FEET FROM THE BANK OF ANY WATERS IN ORDER TO PROTECT WATER QUALITY.

DEBRIS SHALL NOT BE BURIED WITHIN LIMITS OF RIGHT-OF-WAY.

PAY QUANTITIES				
0200 BRIDGE "A" - NBI 13678 - SH-2 OVER FOURCHE MALINE CREEK				
ITEM	DESCRIPTION	UNIT	QUANTITY	
512	6280 CLEANING AND PAINTING BRIDGE METAL RAIL	(2) L.F.	782.00	
512(A)	1323 PAINTING EXISTING STRUCTURES	(1) LSUM.	1.00	
512(B)	6303 COLLECTION & HANDLING OF WASTE	(1) LSUM.	1.00	

PAY QUANTITIES				
0640 CONSTRUCTION				
ITEM	DESCRIPTION	UNIT	QUANTITY	
641	1399 MOBILIZATION	LSUM.	1.00	

BRIDGE "A" SH-2 OVER FOURCHE MALINE CREEK		LATIMER COUNTY		Design	N/A	N/A	
GENERAL NOTES AND SUMMARY OF PAY QUANTITIES (BRIDGE)				Detail	MSW	6/17	
				Check	RAH	6/17	
				Squad:	HEN斯LEY		
				Engr:	DEFRANCO		
STATE OF OKLAHOMA		DEPARTMENT OF TRANSPORTATION					
		JOB/PIECE NO.	33217(05)			SHEET NO.	AB01

REVISIONS		
REV. NO.	DESCRIPTION	DATE

TRAFFIC GENERAL CONSTRUCTION NOTES

EXISTING ROADWAY SHALL REMAIN OPEN DURING CONSTRUCTION. THE CONTRACTOR SHALL BE RESPONSIBLE FOR PROPER BARRICADES, LIGHTS, AND SIGNING WITHIN THE LIMITS OF CONSTRUCTION. ALL CONSTRUCTION SIGNING WILL BE IMPLEMENTED ACCORDING TO CONSTRUCTION PLANS. CONSTRUCTION TRAFFIC CONTROL WILL BE INSTALLED IN A MANNER APPROVED BY THE ENGINEER, IN ACCORDANCE WITH CHAPTER VI OF THE MANUAL ON UNIFORM TRAFFIC CONTROL DEVICES, (CURRENT EDITION), AND COMPLIANT WITH APPLICABLE O.D.O.T. STANDARD DRAWINGS.

THE CONTRACTOR SHALL PROVIDE A PERSON TO BE ON 24 HOUR CALL AS NEEDED AS DETERMINED BY THE ENGINEER. THIS PERSON SHALL HOLD A CURRENT CERTIFICATION FROM THE AMERICAN TRAFFIC SAFETY SERVICE ASSOCIATION (ATSSA) OR THE OKLAHOMA TRAFFIC ENGINEERING ASSOCIATION (OTEA) AS A TRAFFIC CONTROL TECHNICIAN OR TRAFFIC CONTROL SUPERVISOR.

ALL TEMPORARY TRAFFIC CONTROL DEVICES SHALL MEET ODOT'S "QUALITY STANDARDS FOR TEMPORARY TRAFFIC CONTROL DEVICES." CHANNELIZING DEVICES SHALL HAVE A MINIMUM HEIGHT OF 36 INCHES. THE CONTRACTOR SHALL BE RESPONSIBLE FOR THE MAINTENANCE OF THE TEMPORARY TRAFFIC CONTROL DEVICES, AND SHALL BE RESPONSIBLE FOR REPAIRING OR REPLACING ANY DEVICE DURING CONSTRUCTION.

TRAFFIC PAY QUANTITY NOTES

- (TC-26) ALL CONSTRUCTION TRAFFIC CONTROL WILL BE IMPLEMENTED ACCORDING TO CONSTRUCTION PLANS, AND INSTALLED IN A MANNER APPROVED BY THE ENGINEER, IN ACCORDANCE WITH CHAPTER VI OF THE MANUAL ON UNIFORM TRAFFIC CONTROL DEVICES, (CURRENT EDITION), AND COMPLIANT WITH APPLICABLE O.D.O.T. STANDARD DRAWINGS. PRICE BID FOR THIS ITEM SHALL BE PAYMENT IN FULL FOR THE INSTALLATION, MAINTENANCE AND SUBSEQUENT REMOVAL OF ALL NECESSARY CONSTRUCTION TRAFFIC CONTROL DEVICES REQUIRED FOR COMPLETION OF THE PROJECT. ALL SIGNS AND BARRICADES WHICH ARE SHOWN WITH TYPE 'A' LIGHTS IN THE STANDARD DRAWINGS SHALL HAVE THE CORRESPONDING LIGHT ATTACHED DURING NON-DAYLIGHT HOURS.
- (TC-30) INCLUDED IN THIS ITEM ARE ALL S.C.S. (SPECIAL CONSTRUCTION SIGNING) SIGNS WHICH ARE BETWEEN 16.0 S.F. AND 32.99 S.F. ALSO INCLUDED IN THIS ITEM SHALL BE THE COST OF INSTALLATION, MAINTENANCE, AND REMOVAL OF THESE SIGNS.
- (TC-33) ALL CONSTRUCTION WORK ZONE SIGNS SHALL HAVE FLUORESCENT SHEETING. THE FLUORESCENT SHEETING SHALL MEET THE REQUIREMENTS OF ASTM D4956 (LATEST REVISION) THE MANUFACTURER SHALL FURNISH A TYPE 'D' CERTIFICATION IN ACCORDANCE WITH O.D.O.T. STANDARD SPECIFICATIONS (CURRENT EDITION) SUBSECTION 106.04. THE CERTIFICATION SHALL INCLUDE TEST RESULTS ON MATERIAL SUBMITTED FOR APPROVAL.
- (TC-52) ANY USED CHANGEABLE MESSAGE SIGN AND TRUCK MOUNTED ATTENUATOR TO BE PLACED ON THIS PROJECT SHALL BE SUBJECT TO INSPECTION AND APPROVAL BY THE OKLAHOMA DEPARTMENT OF TRANSPORTATION, TO ASSURE THAT THEY ARE IN GOOD WORKING CONDITION, PRIOR TO PLACEMENT ON THE PROJECT.
- (TC-76) ANY TRUCK MOUNTED ATTENUATOR USED ON THIS PROJECT SHALL HAVE PASSED ALL MANDATORY AND OPTIONAL TESTS LISTED IN NCHRP 350, TL-3 CRITERIA. THIS ITEM IS TO BE USED WHERE SHOWN IN THE STANDARD DRAWINGS OR AT THE DISCRETION OF THE ENGINEER ON SHADOW VEHICLES PROTECTING THE WORK AREAS AND TEMPORARY ROADSIDE HAZARDS.
- (TC-77) TRUCK MOUNTED ATTENUATORS ARE TO BE INSTALLED ON NON-STATE OWNED TRUCKS HAVING A MINIMUM GROSS WEIGHT RATING OF 15,000 POUNDS. EACH OF THESE TRUCKS SHALL ALSO BE EQUIPPED WITH AN ARROW DISPLAY (TYPE B).
- (TC-84) 30 CONSTRUCTION CALENDAR DAYS WERE USED TO COMPUTE THE SIGN DAY PAY ITEMS. THE AMOUNT OF CALENDAR DAYS USED TO COMPUTE THE SIGN DAY PAY ITEMS IS AN ESTIMATED QUANTITY ONLY, BASED ON THE CURRENT O.D.O.T. STANDARDS AND SUGGESTED CONSTRUCTION SEQUENCE FOR THIS PROJECT. THESE ESTIMATED SIGN DAY QUANTITIES MAY CHANGE AS THE PROJECT'S CONSTRUCTION TRAFFIC CONTROL IS MODIFIED DURING CONSTRUCTION.
- (TC-85) THESE SIGNS MUST BE ON THE OKLAHOMA DEPARTMENT OF TRANSPORTATION LIST OF APPROVED CHANGEABLE MESSAGE SIGNS. FOR A LIST OF THE APPROVED SIGNS GO TO THE OKLAHOMA DEPARTMENT OF TRANSPORTATION WEBSITE AT: <http://www.okladot.state.ok.us/traffic/qpl/index.php>

SPECIAL NOTES

- (SP-1) PORTABLE CHANGEABLE MESSAGE SIGNS TO BE PLACED WHERE DEEMED NECESSARY BY THE ENGINEER.
- (SP-2) PORTABLE CHANGEABLE MESSAGE SIGN(S) SHALL BE PLACED 14 DAYS PRIOR TO CONSTRUCTION.
- (SP-3) TYPE "C" WARNING LIGHTS ARE NOT REQUIRED.

**PAY QUANTITY SCHEDULE**

0300 TRAFFIC CONTROL

PAY ITEM	CODE NO.	DESCRIPTION	UNIT	QUANTITY
876(A)	8482	(P) TRUCK MOUNTED ATTENUATOR (TC-52, 76, 77, 84)	SD	60.00
880(B)	8818	CONSTRUCTION SIGNS 0 TO 6.25 SF (TC-26, 33, 84)	SD	180.00
880(B)	8821	CONSTRUCTION SIGNS 6.26 SF TO 15.99 SF (TC-26, 33, 84)	SD	60.00
880(B)	8824	CONSTRUCTION SIGNS 16.0 SF TO 32.99 SF (TC-26, 30, 33, 84)	SD	300.00
880(C)	8848	WING BARRICADES (TC-26, 84)	SD	120.00
880(E)	8860	WARNING LIGHTS (TYPE A) (TC-26, 84)	SD	240.00
880(F)	8878	DRUMS (SP-3)(TC-26, 84)	SD	300.00
880(G)	8890	CHANNELIZER CONES (TC-26, 84)	SD	1,530.00
880(I)	8902	FLAGGER (TC-84)	SD	30.00
882(A)	8306	PORT. CHANGEABLE MESSAGE SIGN (SP-1, 2)(TC-52, 84, 85)	SD	88.00



OKLAHOMA DEPARTMENT OF TRANSPORTATION  
TRAFFIC ENGINEERING DIVISION

PREPARED BY:  
KENNETH C. DEDERING, P.E.  
OKLA. REG. NO. 21077  
DATE: 07-10-17



DIVISION 2  
SH-02

LATIMER COUNTY

DETAIL: CLD 06/17  
CHECK: GF 06/17  
ENGINEER: KCD 06/17  
GROUP: ABRAHAM  
EM: MAAROUF

**SUMMARY OF  
PAY QUANTITIES AND NOTES  
(TRAFFIC)**

STATE OF OKLAHOMA

DEPARTMENT OF TRANSPORTATION

JOB/PIECE NO. 33217(05) SHEET NO. AT01

REVISIONS		
REV. NO.	DESCRIPTION	DATE

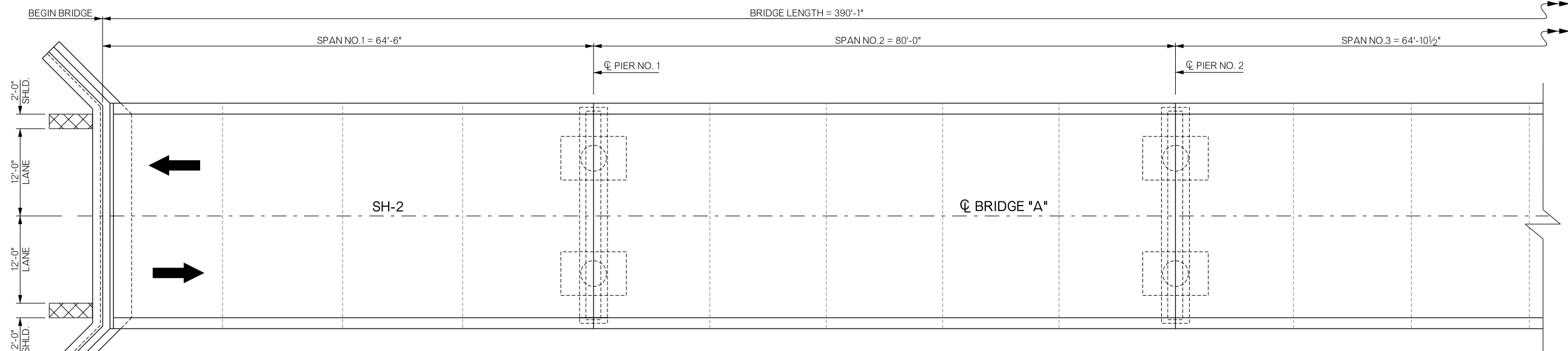
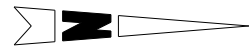

PLAN

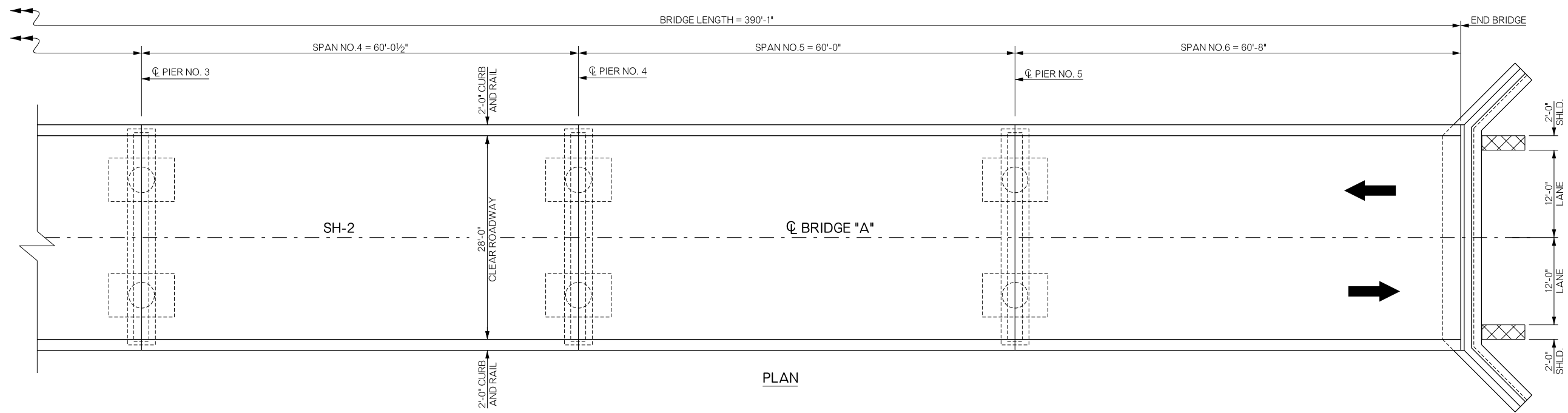

PLAN

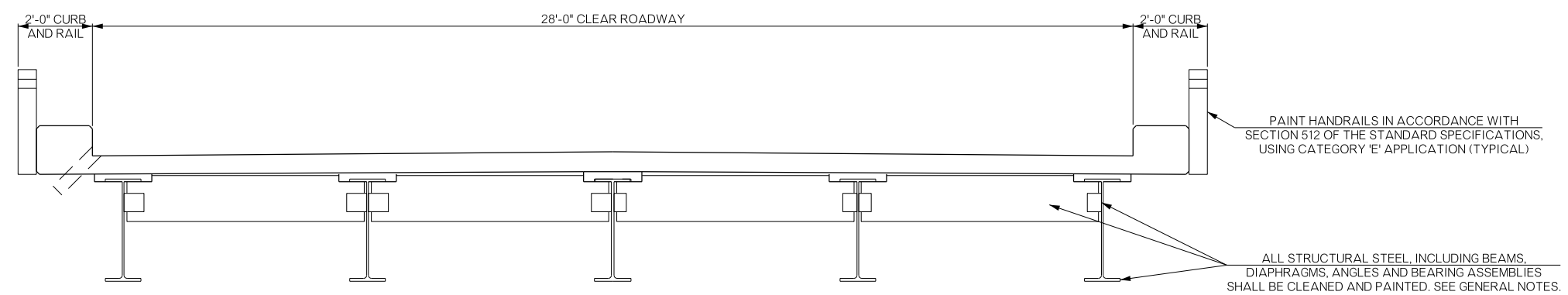

TYPICAL SECTION

BRIDGE "A" SH-2 OVER FOURCHE MALINE CREEK	LATIMER COUNTY	Design	N/A	N/A
GENERAL PLAN AND TYPICAL SECTION (BRIDGE "A")		Detail	DAN	5/17
		Check	RAH	6/17
STATE OF OKLAHOMA		Squad:	HENSFLEY	
DEPARTMENT OF TRANSPORTATION		Engr:	DEFRANCO	
JOB/PIECE NO. 33217(05)	SHEET NO. B001			

REVISIONS		
REV. NO.	DESCRIPTION	DATE

THERE IS NO SUGGESTED SEQUENCE OF CONSTRUCTION IN THIS DRAWING. THE DETAILS SHOWN ARE FOR ONE LANE OF TRAFFIC CONTROL. ALL TRAFFIC CONTROL FOR THE ALTERNATE LANE WILL BE OPPOSITE OF THAT SHOWN.

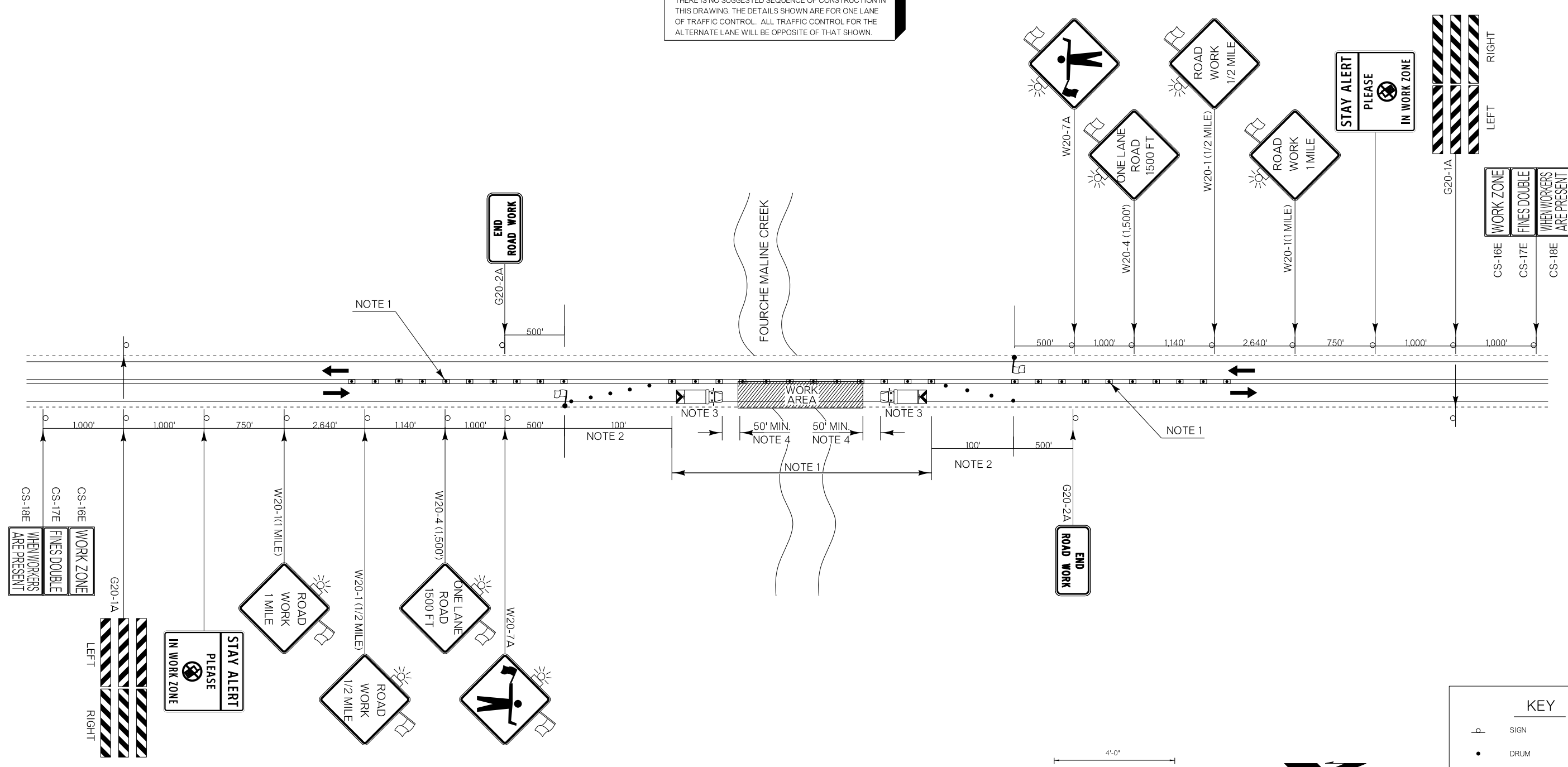

**NOTE 1**  
MAXIMUM SPACING BETWEEN CHANNELIZING DEVICES (FEET) SHALL BE TWICE THE POSTED SPEED LIMIT (M.P.H.) WITH THE FOLLOWING EXCEPTIONS. SPACING SHALL NOT EXCEED 50 FEET FOR CONES OR TUBE CHANNELIZERS. SPACING SHALL NOT EXCEED 75 FEET FOR CHANNELIZER CONES, SPACING SHALL NOT EXCEED 100 FEET FOR TYPE II BARRICADES, VERTICAL PANELS OR DRUMS.

**NOTE 2**  
A MINIMUM OF FIVE (5) CHANNELIZING DEVICES SHALL BE PLACED THROUGH THIS AREA.

**NOTE 3**  
THE SHADOW VEHICLE SHOWN AT THE BEGINNING OF THE WORK AREA SHALL BE IN PLACE WHENEVER WORKERS ARE IN THE WORK AREA. THIS VEHICLE SHALL BE REMOVED FROM THE ROADWAY WHENEVER WORKERS ARE NOT IN THE WORK AREA. THIS VEHICLE SHALL BE EQUIPPED WITH AN ACTUATED FLASHING OR REVOLVING YELLOW LIGHT.

THE FLAGGERS SHALL BE IN SIGHT OF EACH OTHER OR IN DIRECT CONTACT AT ALL TIMES AND SHALL BE POSITIONED TO PROTECT THE WORKERS.

WHEN NO WORK IS BEING PERFORMED AND TWO LANE TRAFFIC IS OPERATING, FLAGGERS WILL NOT BE REQUIRED. WHENEVER FLAGGERS ARE NOT PRESENT, THE "FLAGGER" SIGNS SHALL BE REMOVED OR COVERED.

FLOODLIGHTS SHOULD BE PROVIDED TO MARK FLAGGER STATIONS AT NIGHT AS NEEDED.

**NOTE 4**  
A LONGITUDINAL BUFFER AREA, TO ALLOW WORKERS TIME TO EVACUATE THE WORK AREA, SHOULD BE PROVIDED. FOR GUIDELINES ON SETTING THE LENGTH OF THIS BUFFER, SEE STANDARD DRAWING TCS2-1 (LATEST REVISION). ACTUAL LENGTH SHALL BE DETERMINED BY FIELD CONDITIONS AND THE JUDGEMENT OF THE ENGINEER.

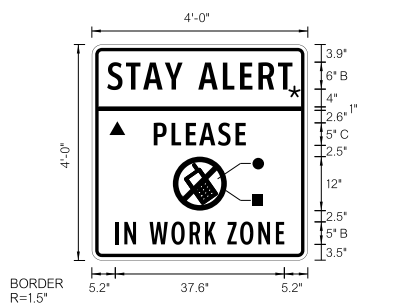

BORDER  
R=1.5"  
TH=0.75"  
IN=0.75"

COLOR:  
LEGEND, SYMBOL AND BORDER  
BLACK (NON-REFLECTORIZED)  
BACKGROUND:  
▲ FLUORESCENT ORANGE (REFLECTORIZED)  
★ FLUORESCENT YELLOW (REFLECTORIZED)  
● WHITE (REFLECTORIZED)  
■ RED (TRANSPARENT)

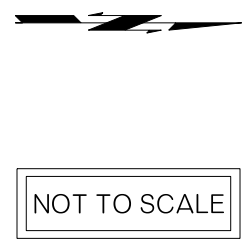

KEY	
	SIGN
	DRUM
	CHANNELIZING CONE
	WORK AREA
	FLAGGER
	SHADOW VEHICLE
	TRUCK MOUNTED ATTENUATOR

DIVISION 2 SH-02	LATIMER COUNTY	DETAIL: CLD 06/17
<b>TRAFFIC CONTROL DETAIL (BRIDGE "A")</b>		CHECK: GF 06/17
		ENGINEER: KCD 06/17
		GROUP: ABRAHAM EM: MAAROUF
STATE OF OKLAHOMA	DEPARTMENT OF TRANSPORTATION	SHEET NO. T001
JOB/PIECE NO. 33217(05)		